

- LEGEND**
- COVENANTED WETLAND PRESERVATION AREA TO REMAIN UNDISTURBED (8,475 SF)
  - COVENANTED NATURALLY VEGETATED WETLAND NON-DISTURBANCE NON-FERTILIZATION BUFFER (WEST SIDE)
  - COVENANTED NATURALLY VEGETATED WETLAND NON-DISTURBANCE NON-FERTILIZATION BUFFER (NORTH/EAST SIDE)
  - PROPOSED LAWN, SEED AT 5 LBS/1,000 SF (4,558 SF)
  - AREA OVER SANITARY SYSTEM TO BE PLANTED WITH NATIVE PLANTS (2,542 SF)
  - AREA TO BE PLANTED WITH NATIVE PLANTS (REFER TO BUFFER PLANTING SPECIFICATIONS FOR SPECIES) (2,562 SF)

**BUFFER PLANTING SPECIFICATIONS**

PROPOSED NON-DISTURBANCE NON-FERTILIZATION BUFFER IS APPROXIMATELY 23,692 SQUARE FEET. SHRUBS AND HERBACEOUS TO BE PLANTED THROUGHOUT ENTIRE BUFFER AREA. SHRUBS TO FORM BORDER HEDGEROW ALONG NORTH AND EAST SIDE OF SITE.

NATIVE PLANTING ABOVE THE SANITARY SYSTEM IS APPROXIMATELY 2,542 SQUARE FEET, TO BE PLANTED WITH PENNSYLVANIA SEDGE (CAREX PENNSYLVANICA), 2' PLUGS PLANTED 6' - 12' ON CENTER.

|            | Scientific Name       | Common Name        | # of Plants                             | Planting Specifications  |
|------------|-----------------------|--------------------|---|--|
| Shrubs     | Anelochia canadensis  | Shadbush           | 256                                     | NORTH and EAST of DWELLING<br>Shrubs to be #3 containers (4-5' height), staggered at 6 feet on center. |
|            | Aronia melanocarpa    | Black chokeberry   |   |  |
|            | Ilex verticillata     | Winterberry        |   |  |
|            | Rosa virginiana       | Virginia rose      |   |  |
|            | Vaccinium corymbosum  | Highbush blueberry |   |  |
|            | Viburnum dentatum     | Southern arrowwood | 402                                     | WEST of DWELLING<br>Shrubs to be #3 containers (4-5' height), staggered at 6 feet on center.           |
|            | Baccharis halimifolia | Groundell bush     |   |  |
|            | Morella pensylvanica  | Northern bayberry  |   |  |
|            | Hibiscus moscheutos   | Rosemallow         |   |  |
|            | Rosa virginiana       | Virginia rose      |   |  |
| Herbaceous | Schizanthus cooperii  | Little bluestem    | (n/a)                                   | NORTH and EAST of DWELLING<br>Quart, plant 18" OC  |
|            | Eupatorium purpureum  | Joe Pye weed       |   |  |
|            | Iris versicolor       | Blue flag iris     |   |  |
|            | Veronica axillaris    | Ironweed           |   |  |
|            | Solidago sempervirens | Seaside goldenrod  |   |  |
|            | Aster novi-belgii     | New York aster     | WEST of DWELLING<br>Quart, plant 18" OC | WEST of DWELLING<br>Quart, plant 18" OC  |
|            | Oenothera biennis     | Evening primrose   |   |  |
|            | Panicum virgatum      | Switchgrass        |   |  |
|            |                       |                    |   |  |
|            |                       |                    |   |  |

**PLANTING METHODS AND SPECIFICATIONS**

**SITE PREPARATION**  
PLANTING SUBSTRATES SHALL BE FREE FROM DEBRIS, NOXIOUS WEEDS, TOXIC SUBSTANCES OR OTHER MATERIALS HARMFUL TO PLANT GROWTH.

**PLANT MATERIAL**  
PLANTS SHALL BE WELL-SHAPED, WELL-GROWN, VIGOROUS PLANTS HAVING HEALTHY AND WELL BRANCHED ROOT SYSTEMS. PLANTS SHALL BE FREE FROM DISEASE, HARMFUL INSECTS AND INSECT EGGS, SUN-SCALD, INJURY, DISFIGUREMENT, AND ABRASION. PLANTS SHALL BE FREE OF SHOCK OR DAMAGE TO BRANCHES, TRUNKS OR ROOT SYSTEMS THAT MAY OCCUR DURING DIGGING AND PREPARATION FOR SHIPMENT, METHOD OF SHIPMENT OR ACTUAL SHIPMENT. PLANTS SHOULD BE FROM A SUITABLE GEOGRAPHIC LOCATION TO ENSURE PROPER ADAPTATION TO LONG ISLAND CLIMATE AND EDAPHIC CONDITIONS. PLANTS SHALL NOT BE INJURED IN HANDLING. PLANTS SHALL NOT BE HANDLED BY THE TRUNK OR STEMS. MATERIALS SHALL NOT BE DROPPED FROM VEHICLES.

**MAINTENANCE**  
RE-VEGETATION AREAS TO BE MULCHED WITH SALT HAY OR PINE NEEDLES AT A RATE OF 75 LBS PER 1,000 SQUARE FEET.

PLANTS SHALL BE IRRIGATED TO ENSURE 1 INCH OF WATER PER WEEK THROUGH NATURAL PRECIPITATION OR SUPPLEMENTED BY IRRIGATION.

ANY PLANTS NOT INSTALLED ON THE DAY OF DELIVERY AT THE PROJECT SITE SHALL BE STORED AND PROTECTED IN DESIGNATED AREAS FROM DIRECT EXPOSURE TO WIND AND SUN. PLANTS MUST NOT BE STORED ON-SITE FOR MORE THAN 7 DAYS BEFORE PLANTING. IF PLANTING IS DELAYED FOR MORE THAN 6 HOURS AFTER DELIVERY, THE PLANTS SHALL BE WATERED.

**SURVIVORSHIP GUARANTEE/MAINTENANCE PERIOD**  
THE APPLICANT SHALL BE RESPONSIBLE FOR ENSURING 85% SURVIVAL OF THE PLANTED VEGETATION OVER TWO (2) GROWING SEASONS. THE PLANT GUARANTEE PERIOD SHALL COMMENCE ON THE DATE OF THE COMPLETION OF CONSTRUCTION, AND SHALL END ON OCTOBER 15 ON THE SECOND GROWING SEASON. PLANT LOSSES DUE TO ATTRIBUTED TO HERBIVORES, DISEASE, DROUGHT, WIND, OR STORM EVENTS SHALL NOT LOWER THE MINIMUM SURVIVAL OR COVERAGE REQUIREMENTS. IF REPLACEMENT PLANTS ARE INSTALLED AT THE END OF THE TWO YEAR PERIOD TO ATTAIN 85% SURVIVAL OR COVERAGE, REPLACEMENT PLANTS SHALL BE GUARANTEED FOR AN ADDITIONAL GROWING SEASON FROM THE DATE OF REPLANTING.

THE ENVIRONMENT DIVISION RESERVES THE RIGHT TO REQUIRE ADDITIONAL NATIVE RE-VEGETATION AND/OR OTHER RESTORATION MEASURES, IN THE EVENT THAT UPON FINAL INSPECTION, A FINDING IS MADE THAT THE GOAL OF ESTABLISHING CONTIGUOUS HEALTHY COVER OF NATIVE OR NATURAL VEGETATION, WITHIN THE DESIGNATED RE-VEGETATION AREAS, HAS NOT BEEN ACHIEVED.

4 SITE PLAN  
L1-NB  
SCALE: 1" = 20'

APPROVED  
MAY 24 2021  
SOUTHAMPTON TOWN  
CONSERVATION BOARD

RECEIVED  
MAY 21 2021  
Town of Southampton  
Environment Division

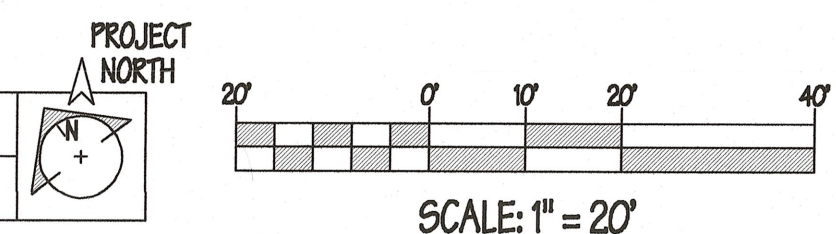

All plans, designs, and ideas shown on this drawing are the property of Brooks Washburn Architect, P.C. and shall not be used, copied, or reproduced in any form without the written permission of Brooks Washburn Architect, P.C.  
Copyright  
Brooks Washburn Architect, P.C.

Member of the  
American Institute of Architects  
Architectural Design  
Interiors/Space Planning  
Site Planning  
Planning/Feasibility  
Architectural Engineering  
Building Energy Analysis  
Building Inspection  
Maintenance and Repair  
22 Depot Street, Suite 16  
Potdam, New York 13676  
brooks@northnet.org  
315.268.1338 tel/fax

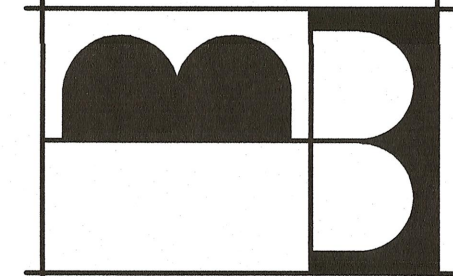

**BROOKS  
WASHBURN  
ARCHITECT PC**  
ENERGY STAR  
PARTNER  
Brooks Washburn, AIA, LEED AP

It is a violation of section 7307 of the New York State Education Law to offer this document, unless doing under the direction of a licensed architect



Drawn DCW  
Checked BW  
Date 10 MAY 18  
14 MAY 18 04 OCT 18  
29 MAY 18 16 DEC 20  
11 JUNE 18  
24 Hoffman - Suffolk, 28081  
Drawings 21808\_11

LOTTE LLC  
474 JOBS LANE  
BRIDGEHAMPTON, NEW YORK  
NATIVE PLANT  
REVEGETATION PLAN  
L1-NB  
Sheet 3 of 3  
Project No 21808